

Options

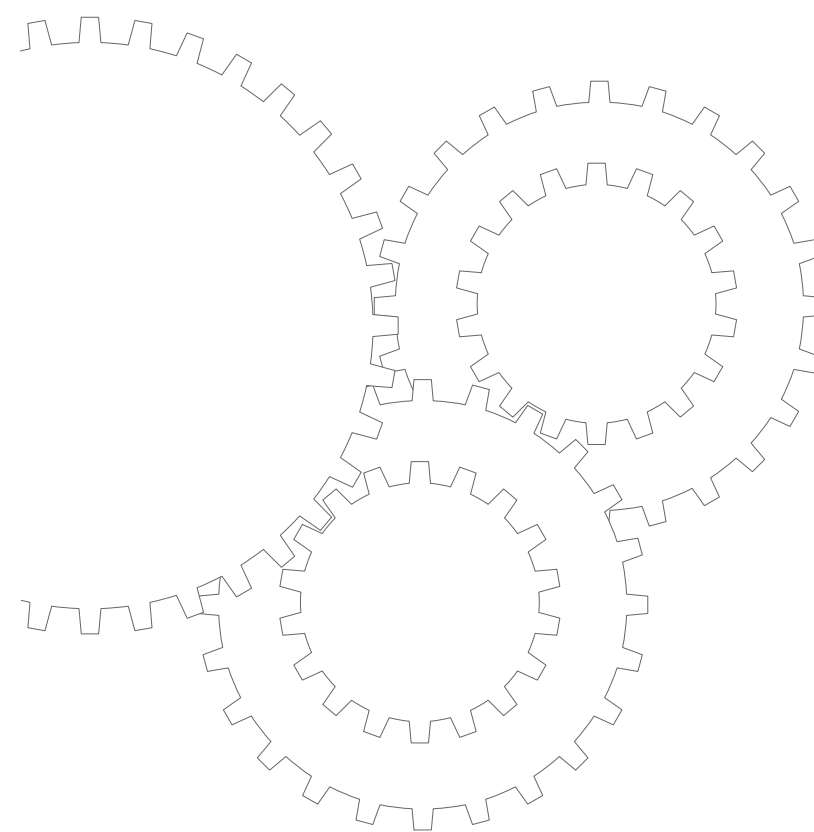

Options

• Mounting frame and dimensions

<Outer-base type*>

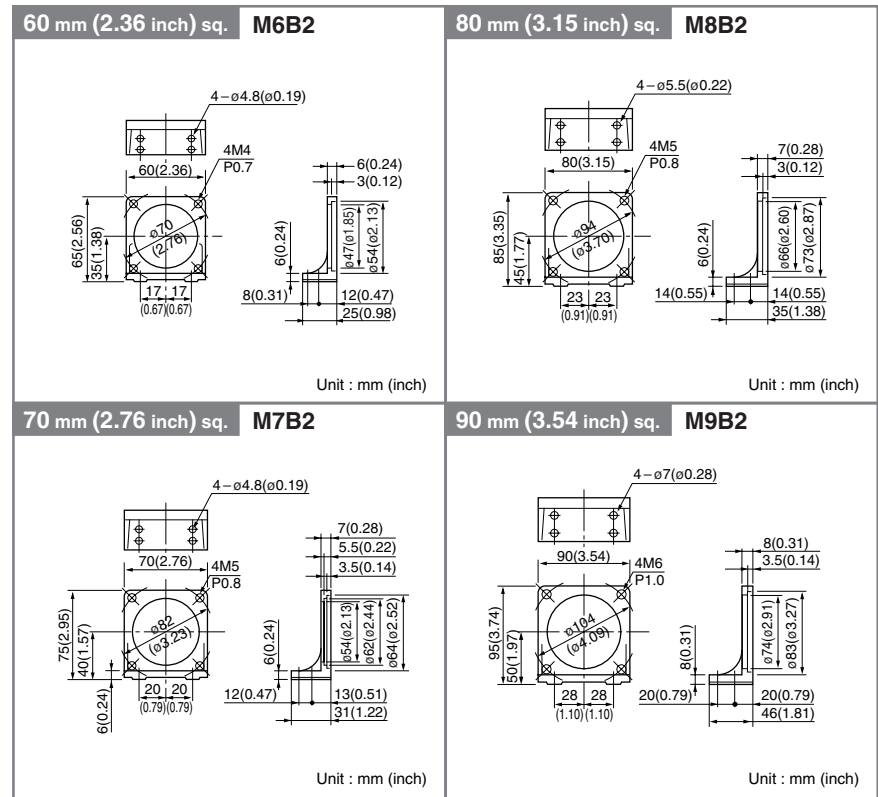

<Inner-base type*>

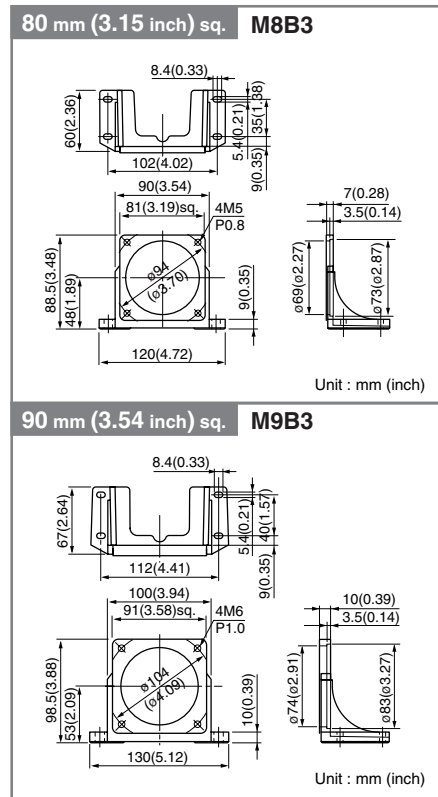

* Not attachable to a hinged gear head or C&B motor.

* Outer-base type: A motor is attached outside the base mounting position.

* Inner-base type: A motor is attached inside the base mounting position.

• Mounting arrangement

Motor + Gear head + Mounting frame

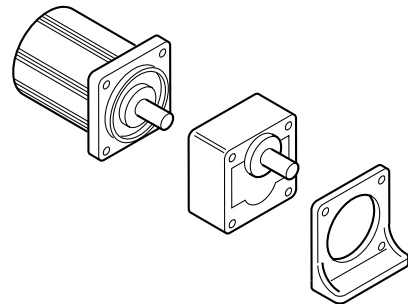

• Application

Size	Mounting frame
	Part No.
60 mm (2.36 inch) sq.	M6B2
70 mm (2.76 inch) sq.	M7B2
80 mm (3.15 inch) sq.	M8B2
	M8B3
90mm (3.54inch) sq.	M9B2
	M9B3

• Decimal gear head mounting screw

Part No.	Size	Supporting model	Standard quantity	Specification
M0PM4001	60 mm (2.36 inch) sq.	MX6G10XB	4 pcs.	Cross recessed pan head screw M4P0.7 x 85(3.35)
M0PM5001	70 mm (2.76 inch) sq.	MX7G10XB	4 pcs.	Cross recessed pan head screw M5P0.8 x 95(3.74)
M0PM5002	90 mm (3.54 inch) sq.	MX8G10XB	4 pcs.	Cross recessed pan head screw M6P1.0 x 115(4.53)
M0PM6002	80 mm (3.15 inch) sq.	MZ9G10XB	4 pcs.	Cross recessed pan head screw M6P1.0 x 65(2.56)
M0PM6003	90mm (3.54 inch) sq.	MX9G10XB	4 pcs.	Cross recessed pan head screw M6P1.0 x 100(3.94)
M0PM6004	90 mm (3.54 inch) sq.	MZ9G10XB	4 pcs.	Cross-recessed hex head bolt M6P1.0 x 125(4.92)

* Please read your User's manual carefully so that you will understand the operation and safety precautions before attempting to operate the system.

• Tachometer (DV0P001)

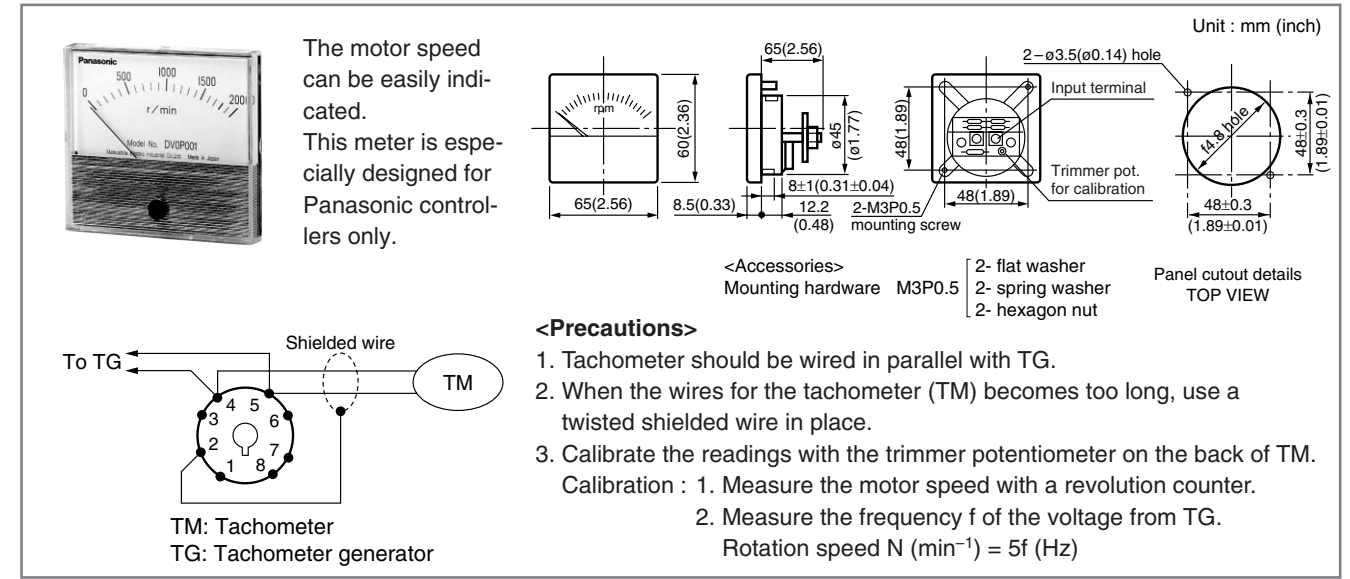

• External speed setter (DV0P002)

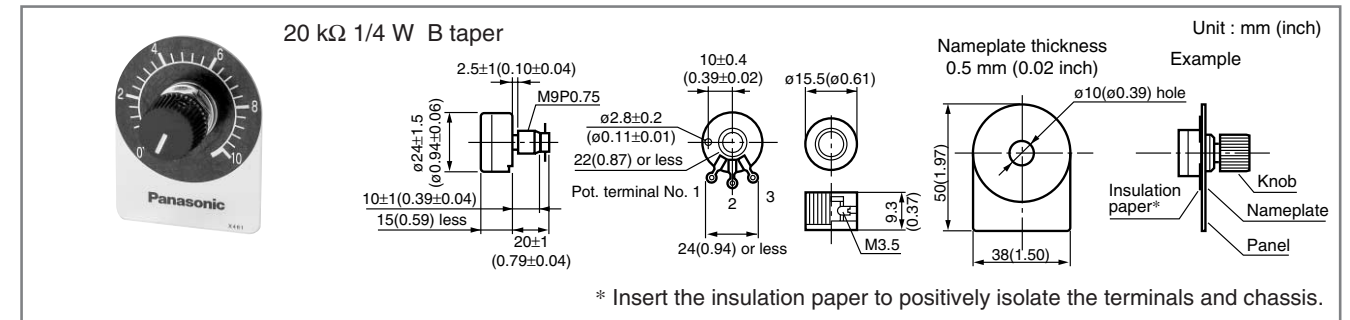

• External braking resistor (DV0P003)

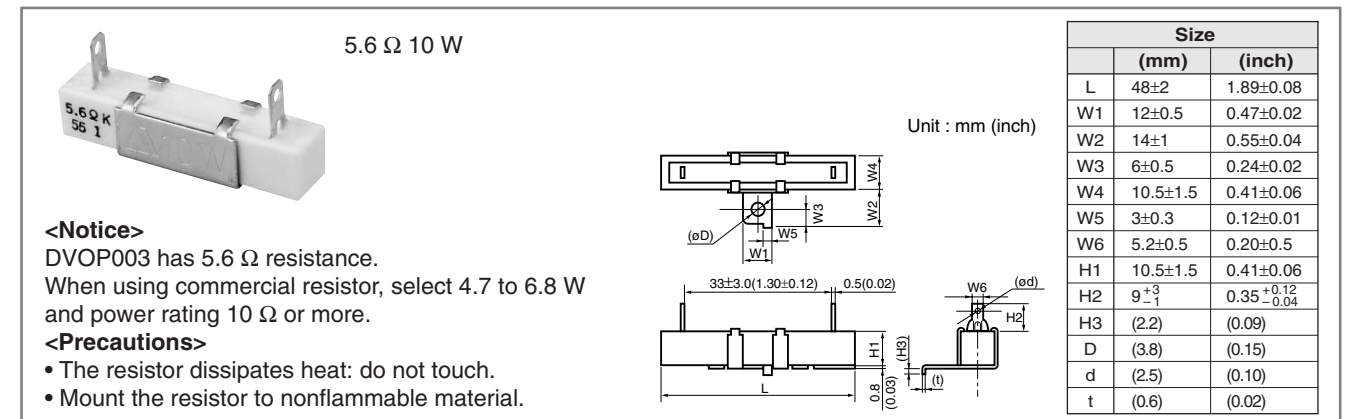

• Spark killer (DV0P008)

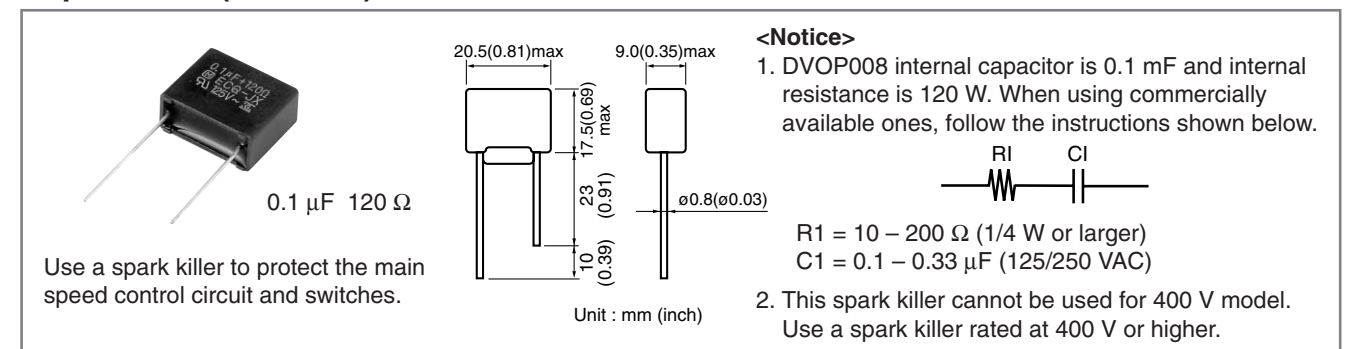

* Please read your User's manual carefully so that you will understand the operation and safety precautions before attempting to operate the system.

• Unit type motor extension cord



DV0P0321

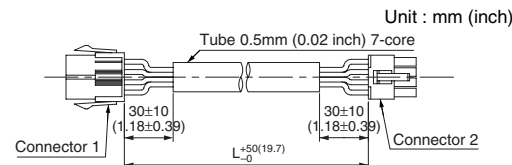

Unit : mm (inch)

Unit : m (inch)

Part No.	Length
DV0P0321	1 (39.37)
DV0P0322	2 (78.74)
DV0P0323	3 (118.11)
DV0P0324	4 (157.48)
DV0P0325	5 (196.85)

The 1 m (39.37 inch) cord is supplied with the motor.

DV0P0322 to DV0P0325

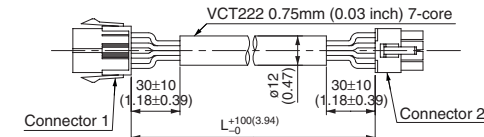

When the distance between the controller and the motor is longer than 1 m (39.37 inch), use a suitable extension cord shown right.

• Capacitor cap

Part No.	W1	W2	W3	W4
M0PC3917	39.5(1.56)	37.5(1.48)	17(0.67)	15(0.59)
M0PC3922	39.5(1.56)	37.5(1.48)	22(0.87)	20(0.79)
M0PC3926	39.5(1.56)	37.5(1.48)	26(1.02)	25(0.98)
M0PC5026	50(1.97)	48(1.89)	26(1.02)	22(0.87)
M0PC5032	50(1.97)	48(1.89)	32.5(1.28)	29.5(1.16)

Unit : mm (inch)

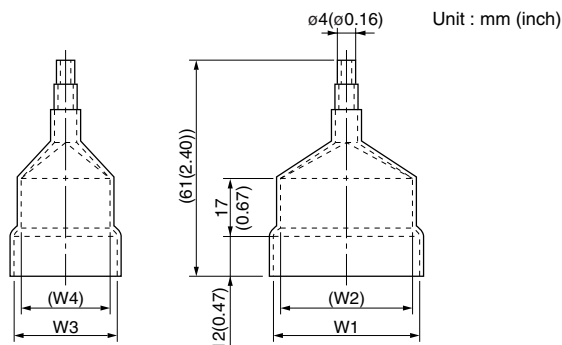

[Notes] 1. 10 caps are packed in one bag.
2. We accept the order for caps in unit of bag.

• Noise filter

DV0P3611-5

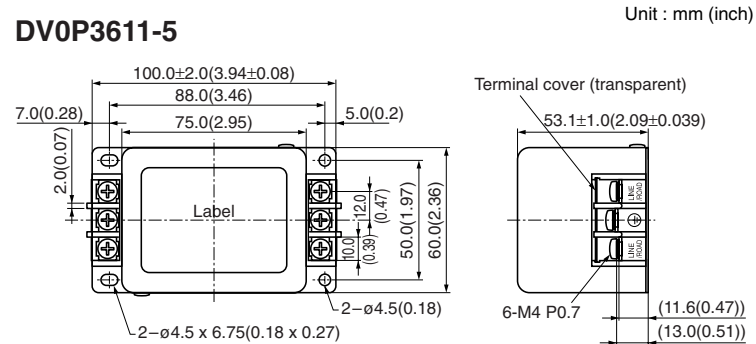

Unit : mm (inch)

<Circuit diagram>

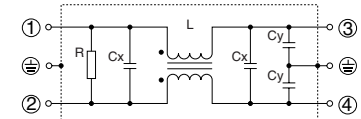

• 8-pin socket

DV0P4560

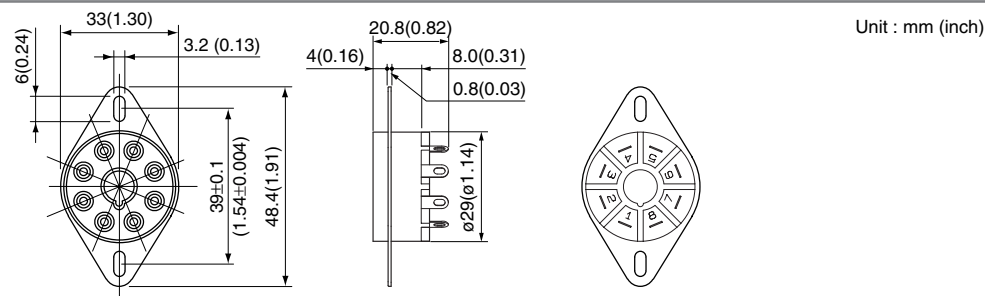

Unit : mm (inch)

* Please read your User's manual carefully so that you will understand the operation and safety precautions before attempting to operate the system.

• Combination of the set and recommended components
(The customer should arrange the recommended components.)
These are products of Matsushita Electric Works, Ltd.

		DIN terminal block	Socket	Cap	Holding spring	Mounting frame	Protective cover	Rail Fastening plate
Speed controller	MGSD	AT7803 ATC180031	AW68102	AD8013	AT7808 (only for MGSD)	AT785* AT781* AT782* AT7831 AT7841 (for flush mounting)	AT7881 (only for MGSD)	—
	EX	AT7803	AW68102 (accessory)	—	—	—	—	—
	SD48 EX48	ATC180031	AW68102	AD8013	—	ATA4811	AQM4801	ATA48011 ATA4806
Brake unit	SD	AT7803	AW68102 (accessory)	AD8013	AT7808 (only for SD)	AT785* AT781* AT782* AT7831 AT7841 (for flush mounting)	—	—
	EX	—	—	—	—	—	—	—
	MB48	ATC180041	—	ATA4861	—	ATA4811	AQM4801	ATA48011 ATA4806

• DIN terminal block

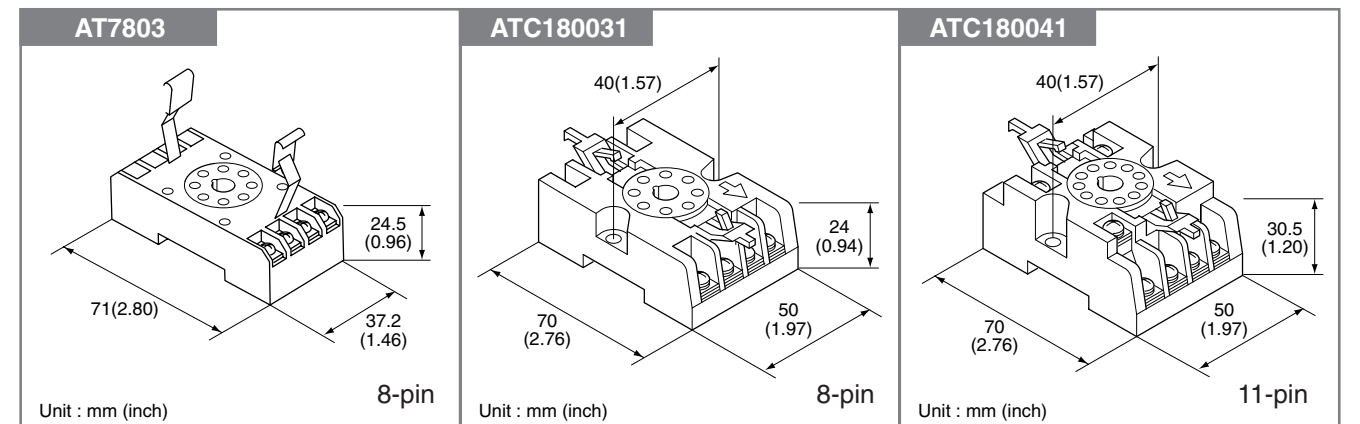

• Socket

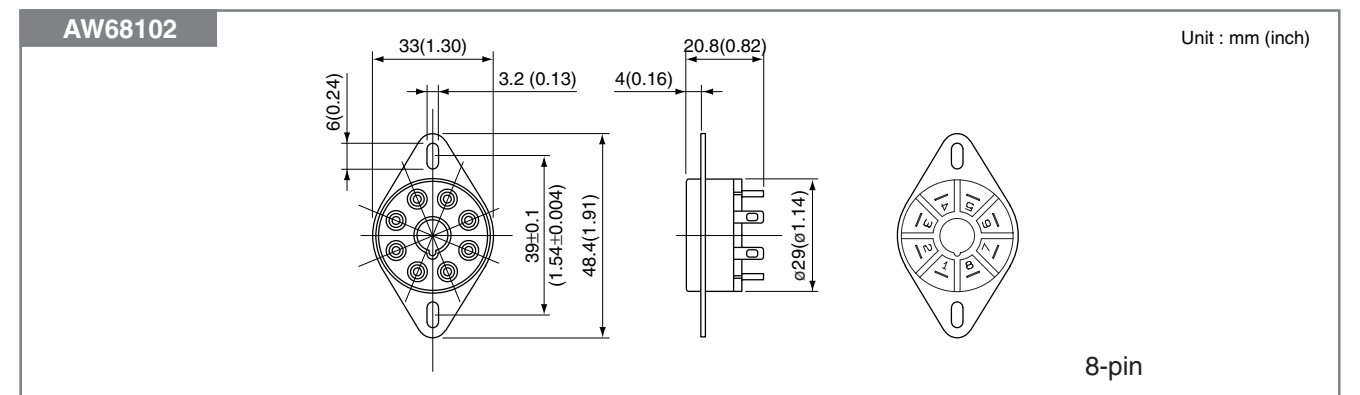

* Please read your User's manual carefully so that you will understand the operation and safety precautions before attempting to operate the system.